



42 St. Mary's Road

Ealing, London, W5 5EU

£335 Per Week

A collection of five studio bedrooms situated in a wonderfully spacious and newly developed property moments walk from University of West London. The property is split over three levels with the ground floor boasting a large communal area with brand new kitchen facilities, with plenty of space for storage, comfortable seating area with patio doors leading out onto a sunny terrace, there is also a laundry room, and additional bathroom, the private bedrooms (single and double) are located on the second and third floors, each studio room is fully finished inc. study desks, wardrobes, beds. All of the rooms have a private en-suite shower room or separate bathroom, and small fridge. The rent is inclusive of utility bills. The property is within 5 mins walk to both South Ealing and Ealing Common stations. The property will be available from from mid February 2026.

**** Bedroom 4 is a large double room and is located on the second floor, and comes fully furnished with private en-suite bathroom, communal kitchen and shared washing facilities ****

- Large Double Studio Room
- Second Floor
- Fully Furnished
- Minutes walk to West London University
- Communal eating/Cooking area
- Communal Terrace

Viewing

Please contact our Messila Residential Office on 020 7586 6699 if you wish to arrange a viewing appointment for this property or require further information.



Floor Plan

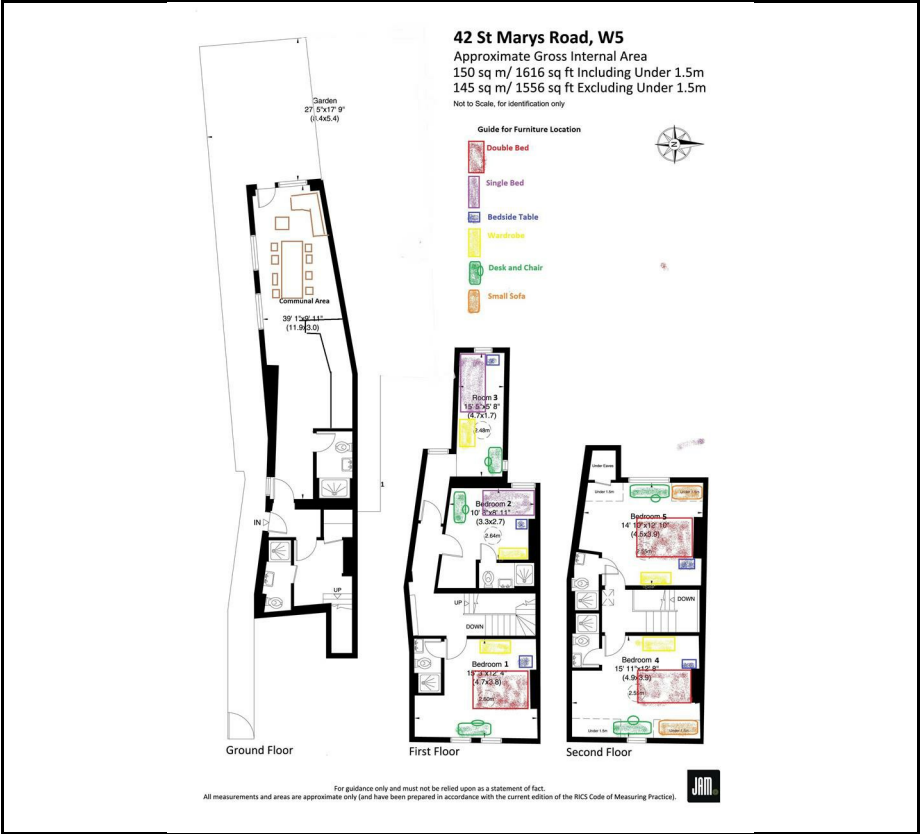

Area Map



Energy Efficiency Graph

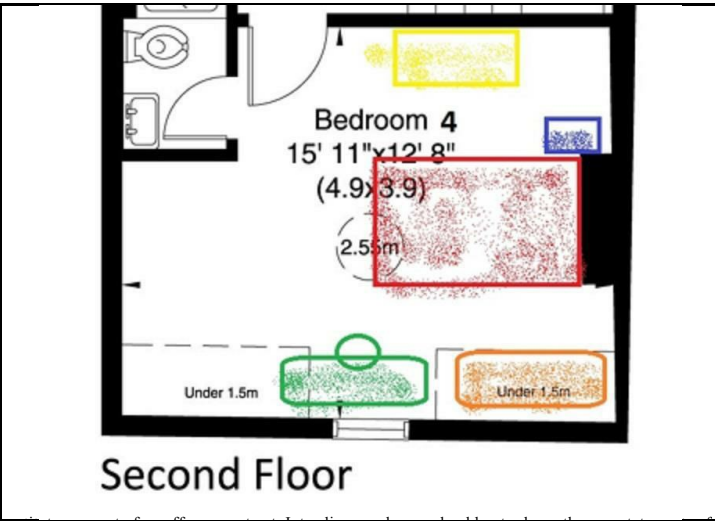
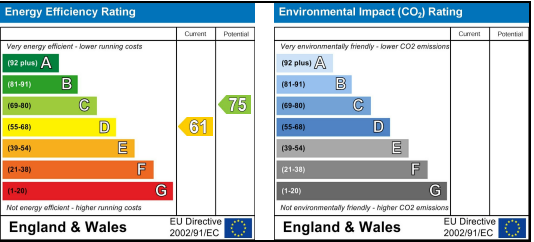

These particulars, whilst believed to be accurate are set out as a general outline only for guidance and do not constitute any part of an offer or contract. Intending purchasers should not rely on them as statements of representation of fact, but must satisfy themselves by inspection or otherwise as to their accuracy. No person in this firm's employment has the authority to make or give any representation or warranty in respect of the property.